

## FSB、FSB-L型离心泵系列

Centrifugal pump series

### 一、概述 Overview

(1) 本泵采用氟塑料合金模压加工制成的, 适用于-30°C~100°C温度条件下长期输送任意浓度的酸、碱、盐溶液、氧化剂及多种强腐蚀性物质, 具有不老化、无毒素分解等优点, 也适用于石油、化工、制药、农药、酸洗、染料、冶炼、造纸、电镀、食品等行业输送液体, 是建设文明工厂的理想设备。

(1) This pump is made of fluorine plastic alloy molding process, suitable for long-term transportation of acid, alkali, salt solution, oxidant and various strong corrosive properties under the temperature condition of -30°C~100°C. Non-toxic decomposition and other advantages, it is also suitable for transporting liquids in petroleum, chemical, pharmaceutical, pesticide, pickling, dye, smelting, papermaking, electroplating, food and other industries. It is an ideal equipment for building a civilized factory.

### (2) 型号意义 Model meaning



### 二、结构示意图 Schematic

#### (1) FSB型

- 1—泵体 Pump body
- 2—叶轮 Impeller
- 3—后座 Rear seat
- 4—压板 Pressing plate
- 5—悬架 Suspension
- 6—集液罩 Liquid collection hood
- 7—机械密封 Mechanical seal
- 8—电机 Motor

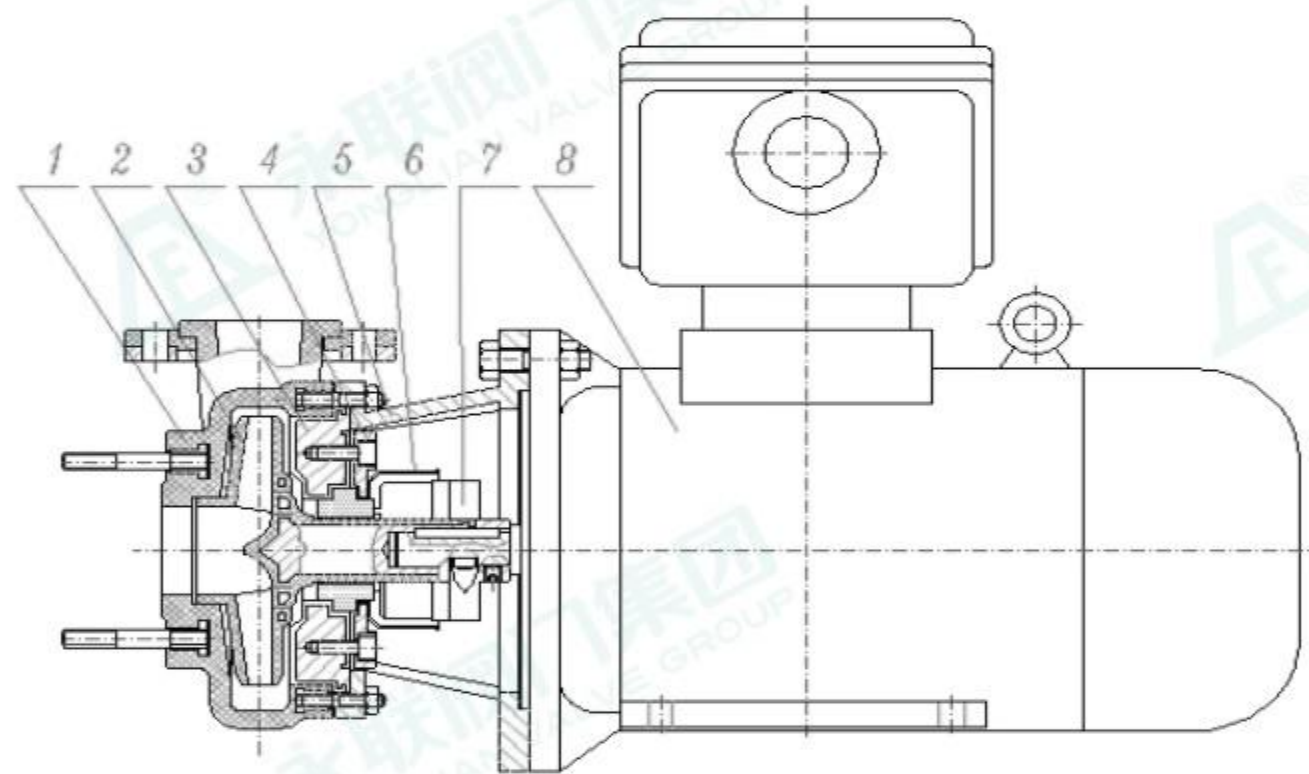

#### (2) FSB-L型

- 1—泵体 Pump body
- 2—叶轮与轴组合 Impeller and shaft combination
- 3—后座 Backseat
- 4—压板 Pressing plate
- 5—集液罩 Liquid collection hood
- 6—机械密封 Mechanical seal
- 7—螺母 Nut
- 8—前轴承盖 Front bearing cover
- 9—轴承 Bearing
- 10—圆形油标 Circular oil pointer
- 11—通气塞 Ventilation plug
- 12—泵轴 Pump shaft
- 13—悬架 Suspension
- 14—后轴承盖 Rear bearing cover
- 15—轴联轴器 Shaft coupling

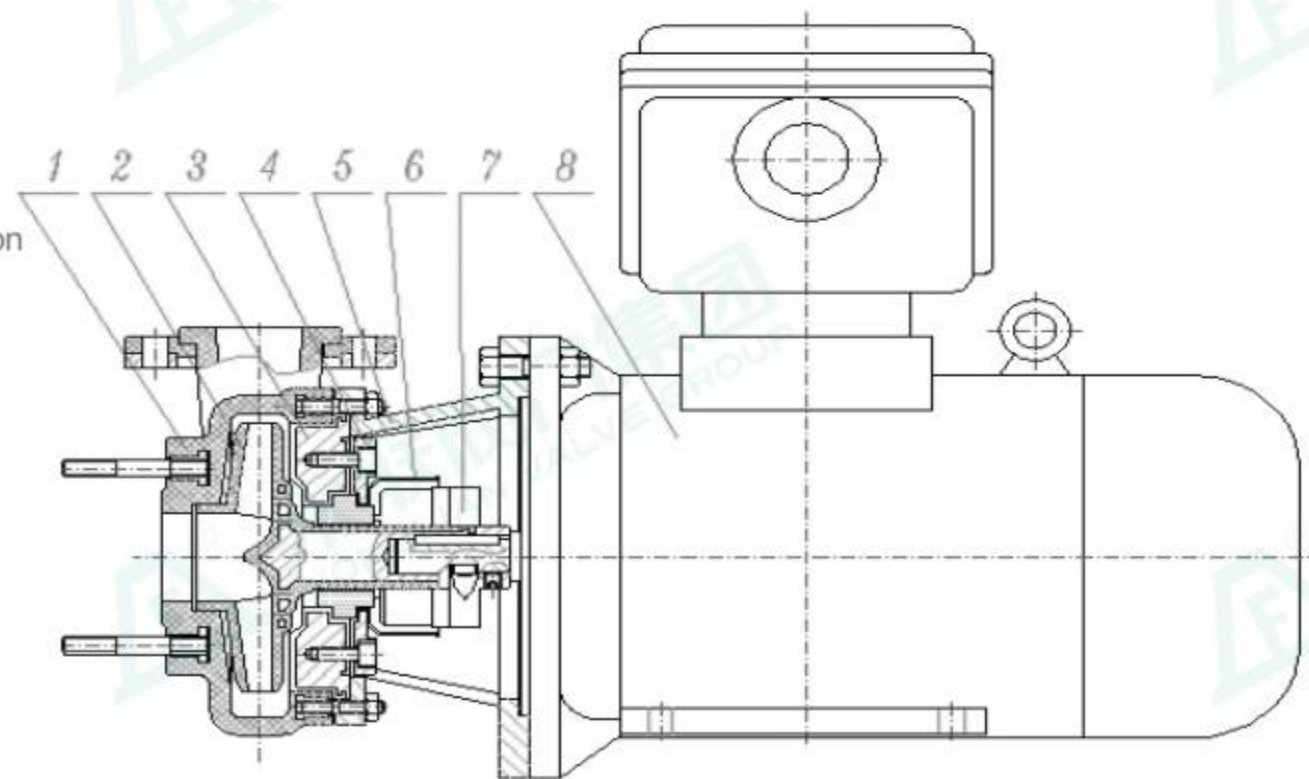

### 三、性能与参数表 Performance and parameter table

#### (1) FSB型

规格型号 Specification model	流量 Traffic (m³/h)	扬程 Lift (m)	口径(mm) Caliber		电机功率 Power (kw)	转速 Speed (r/min)	必需气蚀余量 NPSH (m)	效率 Efficiency (%)
			进口 Import	出口 Export				
25FSB-10	1.5	10	25	20	2.2	2900	4	29
25FSB-18	3.6	18	25	20	2.2	2900	4	27
40FSB-15	10	15	40	32	3	2900	4	51
40FSB-20	10	20	40	32	3	2900	4	47
40FSB-30	10	30	40	32	3	2900	4	55
50FSB-20	15	20	50	40	3	2900	4	55
50FSB-25	15	25	50	40	4	2900	4	64.5
50FSB-30	15	30	50	40	4	2900	4	70
65FSB-32	29	32	65	50	5.5	2900	4.5	70
65FSB-50	29	50	65	40	11	2900	4	69
80FSB-20	50	20	80	65	7.5	2900	4.5	72
80FSB-32	50	32	80	65	11	2900	4.5	64
80FSB-40	50	40	80	50	11	2900	3	66
80FSB-50	50	50	80	50	15	2900	3	73
100FSB-40	100	40	100	80	18.5	2900	4	70
100FSB-50	100	50	100	65	22	2900	4	75

#### (2) FSB-L型

规格型号 Specification model	流量 Traffic (m³/h)	扬程 Lift (m)	口径(mm) Caliber		电机功率 Power (kw)	转速 Speed (r/min)	必需气蚀余量 NPSH (m)	效率 Efficiency (%)
			进口 Import	出口 Export				
25FSB-10L	1.5	10	25	20	2.2	2900	4	29
25FSB-18L	3.6	18	25	20	2.2	2900	4	27
40FSB-15L	10	15	40	32	3	2900	4	51
40FSB-20L	10	20	40	32	3	2900	4	47
40FSB-30L	10	30	40	32	3	2900	4	55
50FSB-20L	15	20	50	40	3	2900	4	55
50FSB-25L	15	25	50	40	4	2900	4	64.5
50FSB-30L	15	30	50	40	4	2900	4	70
65FSB-32L	29	32	65	50	5.5	2900	4.5	70
65FSB-50L	29	50	65	40	11	2900	4	69
80FSB-20L	50	20	80	65	7.5	2900	4.5	72
80FSB-32L	50	32	80	65	11	2900	4.5	64
80FSB-40L	50	40	80	50	11	2900	3	66
80FSB-50L	50	50	80	50	15	2900	3	73
100FSB-40L	100	40	100	80	18.5	2900	4	70
100FSB-50L	100	50	100	65	22	2900	4	75

**FSB、FSB-L型离心泵系列**  
Centrifugal pump series

**FSB、FSB-L型离心泵系列**  
Centrifugal pump series

**四、外形及安装尺寸**  
Shape and installation dimensions

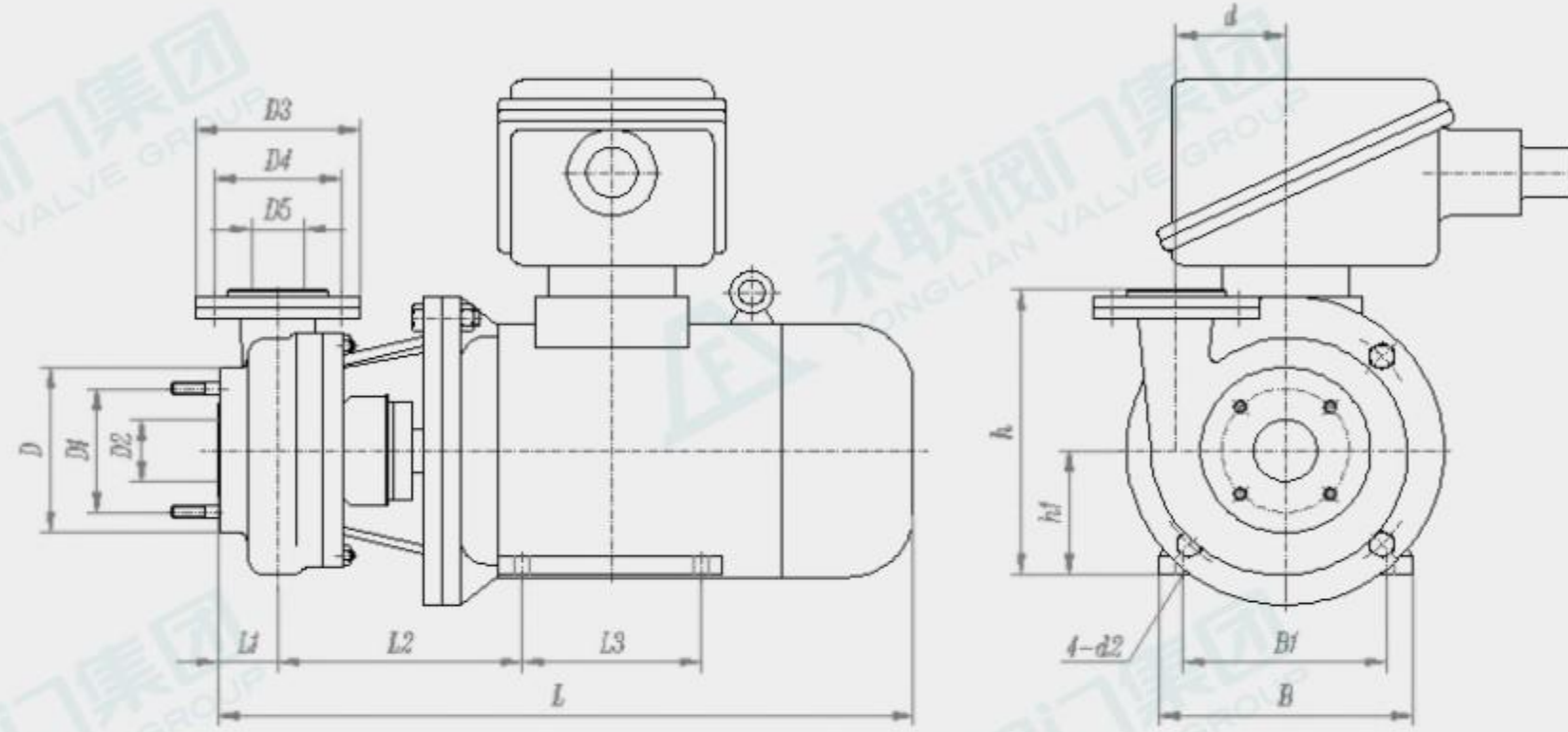

**四、外形及安装尺寸**  
Shape and installation dimensions

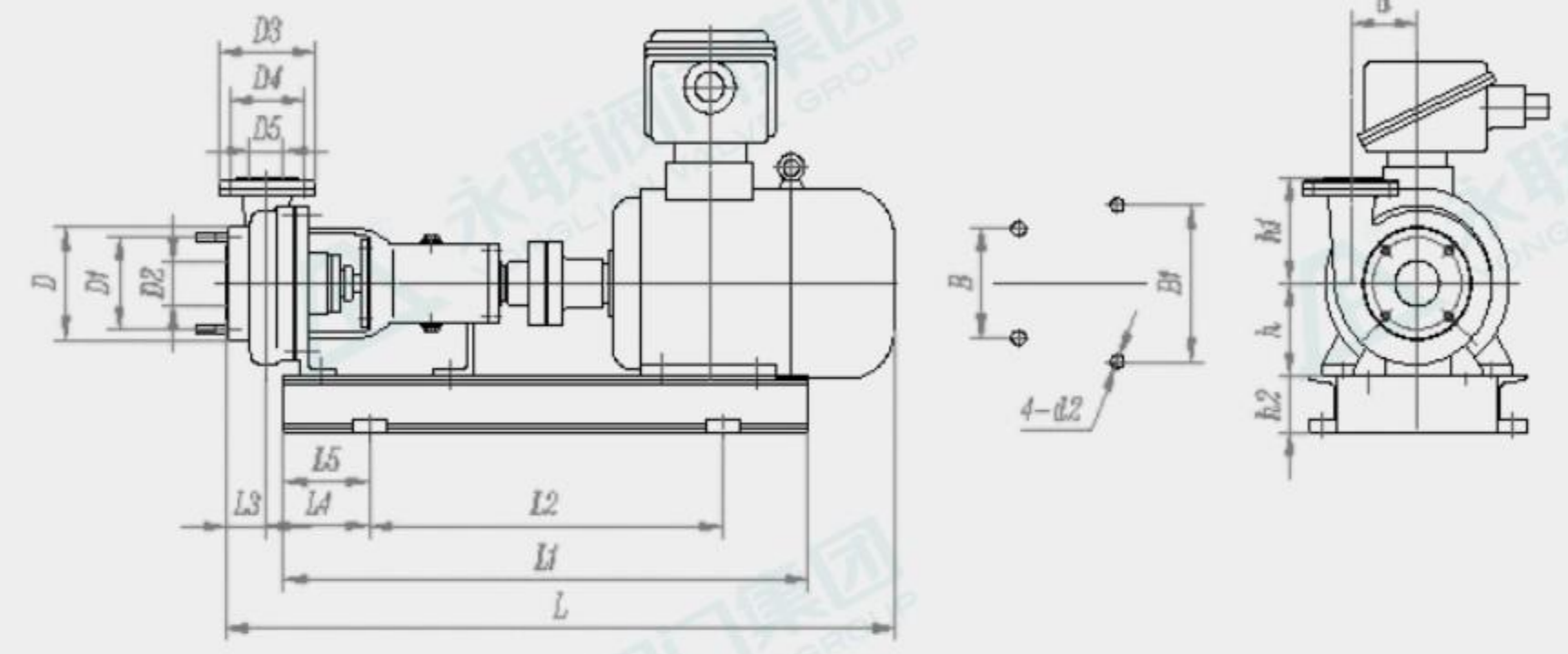

(1) FSB型

规格型号 Specification Model	L	L1	L2	L3	D	D1	D2	D3	D4	D5	B	B1	d	h	h1	4-d2
25FSB-10	435	40	185	100	100	75	25	90	65	20	180	140	67	210	90	4-Φ10
25FSB-18	435	40	185	100	100	75	25	90	65	20	180	140	67	210	90	4-Φ10
40FSB-15	509	58	193	140	132	100	40	130	100	32	205	160	86	230	100	4-Φ12
40FSB-20	509	58	193	140	132	100	40	130	100	32	205	160	86	230	100	4-Φ12
40FSB-30	509	58	193	140	132	100	40	130	100	32	205	160	86	230	100	4-Φ12
50FSB-20	509	58	193	140	132	100	50	130	100	40	205	160	86	230	112	4-Φ12
50FSB-25	529	58	200	140	132	100	50	130	100	40	240	190	86	242	112	4-Φ12
50FSB-30	529	58	200	140	132	100	50	130	100	40	240	190	86	242	112	4-Φ12
65FSB-32	600	60	234	140	160	130	65	140	110	50	280	216	97	282	132	4-Φ12
65FSB-50	742	70	284	210	200	160	65	165	125	40	330	254	120	360	160	4-Φ12
80FSB-20	787	65	280	210	185	150	80	160	130	65	330	254	108	325	160	4-Φ12
80FSB-32	677	65	261	140	185	150	80	160	130	65	280	216	108	297	132	4-Φ12
80FSB-40	776	70	284	254	200	160	80	165	125	50	330	254	120	360	160	4-Φ14
80FSB-50	776	70	284	254	200	160	80	165	125	50	330	254	120	360	160	4-Φ14
100FSB-40	798	60	310	254	220	160	100	200	160	80	330	254	120	360	160	4-Φ14
100FSB-50	830	60	310	241	220	180	100	185	145	80	355	279	125	380	180	4-Φ14

(2) FSB-L型

规格型号 Specification Model	L	L1	L2	L3	L4	L5	D	D1	D2	D3	D4	D5	B	B1	d	h	h1	h2	4-d2
25FSB-10L	716	620	385	40	130	117.5	100	75	25	90	65	20	230	280	67	100	120	70	4-Φ14
25FSB-18L	716	620	385	40	130	117.5	100	75	25	90	65	20	230	280	67	100	120	70	4-Φ14
40FSB-15L	846	710	460	58	185	125	132	100	40	130	100	32	255	310	86	132	130	80	4-Φ18
40FSB-20L	846	710	460	58	185	125	132	100	40	130	100	32	255	310	86	132	130	80	4-Φ18
40FSB-30L	846	710	460	58	185	125	132	100	40	130	100	32	255	310	86	132	130	80	4-Φ18
40FSB-50L	936	825	500	62	150	162.5	165	125	40	160	125	32	365	365	110	160	180	70	4-Φ14
50FSB-20L	985	770	520	48	150	125	135	100	50	130	100	32	280	280	86	132	130	80	4-Φ16
50FSB-25L	866	710	460	58	185	125	132	100	50	130	100	40	255	310	86	132	130	80	4-Φ18
50FSB-30L	985	770	520	48	150	125	135	100	50	130	100	32	280	280	86	132	130	80	4-Φ15
50FSB-50L	936	825	500	62	150	162.5	165	125	50	160	125	32	365	365	110	160	180	70	4-Φ18
65FSB-32L	985	770	520	60	150	125	160	130	65	140	110	50	280	280	97	132	150	80	4-Φ16
65FSB-50L	1207	950	610	69	150	170	200	160	65	165	125	40	330	395	122	160	200	100	4-Φ18
80FSB-20L	1002	888	560	65	195	164	185	150	80	160	130	65	290	410	108	160	165	80	4-Φ18
80FSB-30L	1015	770	520	74	180	125	182	150	80	160	130	65	280	280	95	160	165	80	4-Φ16
80FSB-32L	1015	770	520	74	180	125	182	150	80	160	130	65	280	280	95	160	165	80	4-Φ18
80FSB-40L	1207	950	610	69	150	170	200	160	80	165	125	50	330	395	113	160	200	100	4-Φ18
80FSB-50L	1207	950	610	69	150	170	200	160	80	165	125	50	330	395	122	160	200	100	4-Φ18
100FSB-40L	1215	990	520	72	175	235	220	180	100	200	160	80	330	425	117	160	200	115	4-Φ18
100FSB-50L	1270	1060	690	72	175	185	220	180	100	185	145	65	330	470	125	180	200	115	4-Φ18

**FSB、FSB-L型离心泵系列**  
Centrifugal pump series

**五、FSB、FSB-L型氟合金离心泵的操作与使用 Operation and use of fluorine alloy centrifugal pump**

**(1) 泵的安装**

- 泵应水平安装，不得使泵体承受管路重力。
- 应尽可能保证输送介质的液面高于泵轴中心线，如略低时应加装底阀（因该型号泵不具备自吸性能，如有需要请选用相应自吸泵）。
- 泵的进出口都应加装控制阀，建议出口管路加装流量计或压力表。
- 若输送的介质中有微量固体颗粒，应在泵的入口加装过滤网（若含铁磁微粒，应加装磁性过滤器）。
- 为确保泵的安全运行，推荐加装我厂生产的BBD2型泵类干摩擦保护器。
- The pump should be installed horizontally, and the pump body must not be subjected to the gravity of the pipeline.
- It should be ensured that the liquid level of the conveying medium is higher than the center line of the pump shaft as much as possible. If it is slightly lower, a foot valve should be installed (because this type of pump does not have self-priming performance, please use the corresponding self-priming pump if necessary).
- The inlet and outlet of the pump should be equipped with control valves. It is recommended to install a flow meter or pressure gauge on the outlet pipeline.
- If there are trace solid particles in the conveyed medium, a filter screen should be installed at the inlet of the pump (if ferromagnetic particles are contained, a magnetic filter should be installed).
- In order to ensure the safe operation of the pump, it is recommended to install the BBD2 pump type dry friction protector produced by our factory.

**(2) 泵的启动与停车**

- 泵启动前应全开进口控制阀和排气阀，关闭出口控制阀，待泵腔内灌满液体后再关闭排气阀。
- 使用前先启动几秒钟，检查电机运转方向是否与泵的旋转标志一致，并检查泵腔内是否有液。
- 泵启动后，出口控制阀缓慢开启至泵额定工况点运行，严禁使用调节进口控制阀得到理想流量的方法。
- 泵停止运行时，应先关闭出口控制阀，再关闭电源，最后关闭进口控制阀。
- 若输送介质会沉淀，停车后应及时清洗（严禁输送结晶体和带固体颗粒的介质）。
- Before starting the pump, fully open the inlet control valve and exhaust valve, close the outlet control valve, and close the exhaust valve after the pump cavity is filled with liquid.
- Start a few seconds before use, check whether the motor rotation direction is consistent with the pump rotation mark, and check whether there is liquid in the pump cavity.
- After the pump is started, the outlet control valve is slowly opened to the rated operating point of the pump. It is strictly forbidden to use the method of adjusting the inlet control valve to obtain the ideal flow.
- When the pump stops running, the outlet control valve should be closed first, then the power supply, and finally the inlet control valve should be closed.
- If the conveying medium will precipitate, it should be cleaned in time after parking (it is strictly forbidden to convey crystals and medium with solid particles).

**(3) 泵在使用中如发现噪音过大，振动剧烈或其它不正常现象时，应立即停机检查，待故障排除后方能继续工作。**

If the pump finds excessive noise, violent vibration or other abnormal phenomena during use, it should be shut down immediately for inspection, and can continue to work after the fault is eliminated.

**六、FSB、FSB-L型氟合金离心泵常见故障分析与排除方法 Common fault analysis and troubleshooting**

故障现象 Fault phenomenon	原因分析 Cause analysis	排除方法 Exclusion method
泵不出水 Pump does not discharge water	1. 泵反转 1. Pump reversal 2. 进口管路漏气 2. Air leakage in the inlet pipeline 3. 泵腔储液不足 3. Insufficient liquid storage in the pump chamber 4. 电压太高，启动时联轴器打滑 4. Voltage too high, coupling slipping during startup 5. 阀门没有打开 5. The valve is not open	1. 调整电机旋转方向 1. Pump reversal 2. 杜绝漏气 2. Air leakage in the inlet pipeline 3. 增加储液量 3. Insufficient liquid storage in the pump chamber 4. 调整电压 4. Voltage too high, coupling slipping during startup 5. 校正或改变阀门 5. The valve is not open
流量不足 Insufficient traffic	1. 进口管路太小 1. The inlet pipeline is too small 2. 管路或叶轮流道被杂物阻塞 2. The pipeline or impeller passage is blocked by debris 3. 扬程过高 3. The head is too high	1. 更换进口管路 1. Replace the inlet pipeline 2. 清除堵塞杂物 2. Remove blocked debris 3. 调大出口控制阀 3. Increase the outlet control valve
扬程过低 Head too low	1. 流量过大 1. Excessive flow 2. 转速不够 2. Insufficient speed 3. 叶轮损坏 3. Impeller damage 4. 输送介质内有空气 4. There is air in the conveying medium 5. 输送介质比重过大 5. The specific gravity of the conveying medium is too high	1. 调小出口控制阀 1. Reduce the outlet control valve 2. 检查电机或供电线路 2. Check the motor or power supply circuit 3. 更换叶轮 3. Replace the impeller 4. 重新灌注液体或排空气体 4. Recharge liquid or empty gas 5. 降低介质粘度或适当增加灌注压力 5. Reduce medium viscosity or increase injection pressure appropriately
噪音太大 泵组振动 The noise is too loud Pump set vibration	1. 轴承严重磨损 1. Severe bearing wear 2. 有机械摩擦 2. Mechanical friction 3. 有汽蚀现象产生 3. There is cavitation phenomenon	1. 更换轴承 1. Replace the bearing 2. 检查何处摩擦并进行检修 2. Check for any friction and perform maintenance 3. 降低的安装高度，减少吸入管路阻力以及降低泵，送液体温度，and lower the temperature of the pump and liquid delivery
密封泄漏严重 Severe seal leakage	1. 轴封严重磨损 1. The shaft seal is severely worn	1. 更换轴封 1. Replace the shaft seal

**IHF型氟塑料合金离心泵**  
Fluoroplastic alloy centrifugal pump

**一、结构特性 Structural characteristics**

泵壳材料为铸钢、球墨铸铁，其过流的内表面模压衬上一层4~5mm厚的F50-1。叶轮是以碳钢连体模压F50-1，具有传递扭力大、耐腐蚀性强的特点。技术特征符合GB5660 (ISO3661)、GB5662 (ISO2858)的规定。其主要零部件有：泵体、泵盖、叶轮、轴、托架（悬架）、机械密封等，采用后开门式，不需拆卸管路系统就可以进行维修。叶轮是闭式带有副叶片，用以平衡轴向力和减低轴封压力，轴承为稀油润滑。从电动机端看泵，泵为顺时针方向旋转。

The material of the pump casing is cast steel and ductile iron, and the inner surface of its overflow is lined with a layer of F50-1 with a thickness of 4-5mm. The impeller is made of carbon steel one piece molded F50-1, which has the characteristics of large torque transmission and strong corrosion resistance. The technical features meet the requirements of GB5660 (ISO3661) and GB5662 (ISO2858). Its main components are: pump body, pump cover, impeller, shaft, bracket (suspension), mechanical seal, etc. The rear door type is adopted, and maintenance can be carried out without disassembling the pipeline system. The impeller is a closed type with auxiliary vanes to balance the axial force and reduce the pressure of the shaft seal. The bearings are lubricated with thin oil. Looking at the pump from the motor end, the pump rotates clockwise.

**二、型号意义 Model meaning**

例：IHF50—32—160



**三、结构示意图 Schematic**

1. 泵体
2. 叶轮
3. 后座
4. 压板
5. 集液罩
6. 机械密封
7. 螺栓
8. 托架
9. 螺母
10. 前轴承盖
11. 轴承
12. 通气塞
13. 泵轴
14. 放油塞
15. 油标
16. 后轴承盖
17. 泵联轴器
18. 弹性块
19. 电机联轴器
20. 防护罩
21. 电机
22. 底座

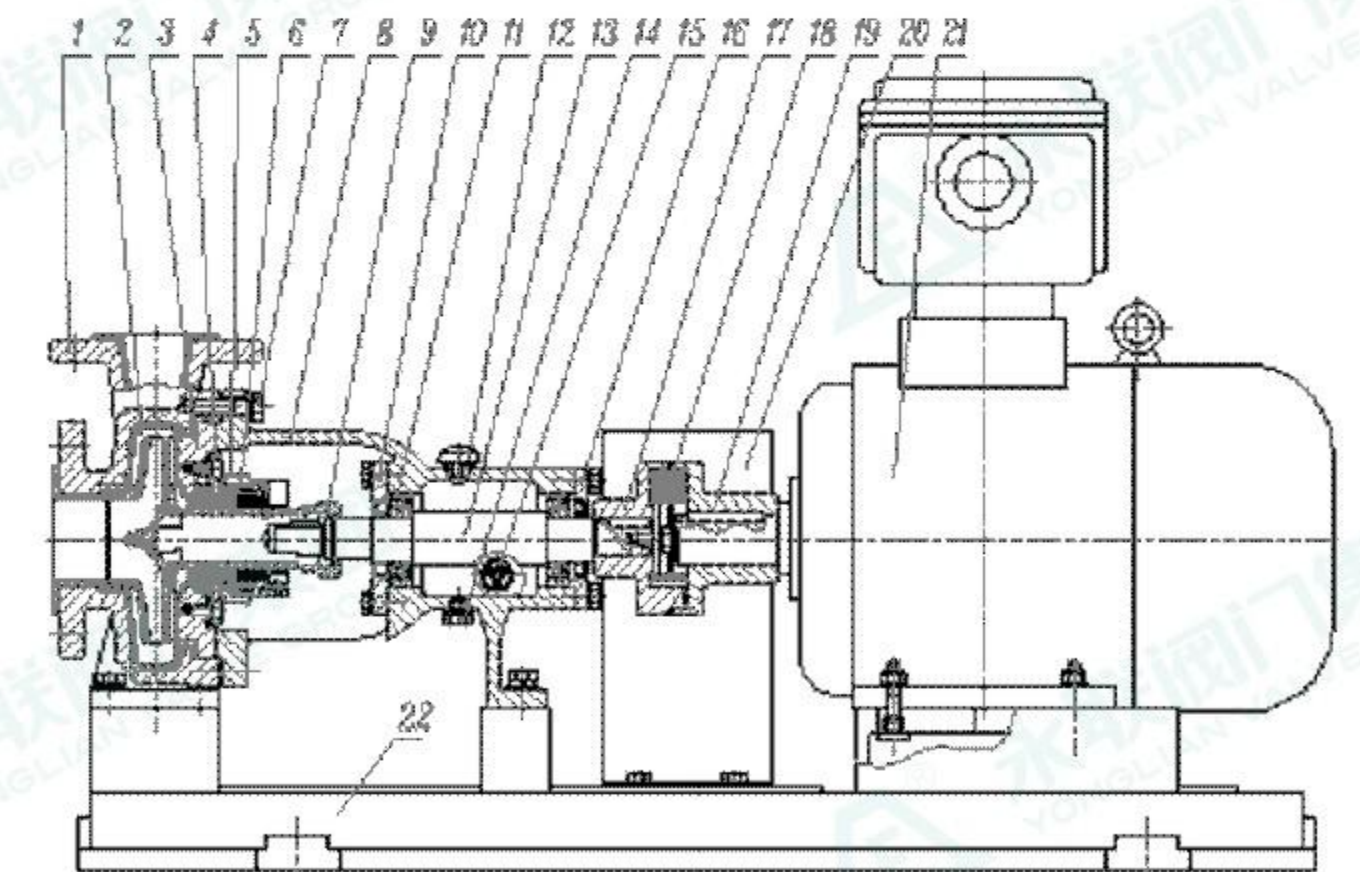

G

**IHF型氟塑料合金离心泵**  
Fluoroplastic alloy centrifugal pump

衬氟水泵系列  
Fluorine Lined Water Pump Series

**四、性能与参数表 Performance and parameter table**

规格型号 Specification and model	口径φ(mm) Caliber φ(mm)		流量Q Flow Q		扬程H (m) Head	转速n (r/min) Speed	功率Pa(kw) Power		效率η (%) Efficiency	气蚀余量 (m) Net positive suction head
	进口 Import	出口 Export	(m³/h)	(L/s)			轴功率 Shaft power	配用功率 Allocated power		
IHF40-25-125	40	25	6.3	1.75	20	2900	0.98	2.2	35	2.5
IHF40-25-160					32		1.66	3	33	
IHF50-32-125	50	32	12.5	3.47	20	2900	1.31	3	52	3.0
IHF50-32-160					32		2.2	4	49	
IHF50-32-200					50		4.1	5.5~7.5	42	
IHF65-50-125	65	50	25	6.94	20	2900	2.13	4	64	3.5
IHF65-50-160					32		3.63	5.5	60	
IHF65-40-200		40			6.30		11	54		
IHF80-65-160	80	65	50	13.9	32	2900	6.7	11	65	4.0
IHF80-50-200					50		11.5	15	60	
IHF100-80-160	100	80	100	27.8	32	2900	12.7	18.5	65	5.0
IHF100-65-200		65			18.91		30	60		
IHF125-100-160	125	100	193.4	53.7	22	2900	16.5	30	70	5.0
IHF150-125-315	150	125	200	55.6	32	1470	25	30	70	5.0

注: 如用户所需参数不在此表范围, 我公司可根据用户要求予以调整, 当输送介质比重大于或小于1时, 泵的配套功率应做适当调整。  
具体请致电: 0577-8681 0423 / 2886 6111

Note: If the parameters required by the user are not within the scope of this table, our company can adjust them according to the user's requirements; When the specific gravity of the conveying medium is greater than or less than 1, the matching power of the pump should be adjusted appropriately.  
For details, please call 0577-8681 0423/2886 6111

**五、外形及安装尺寸 Shape and installation dimensions**

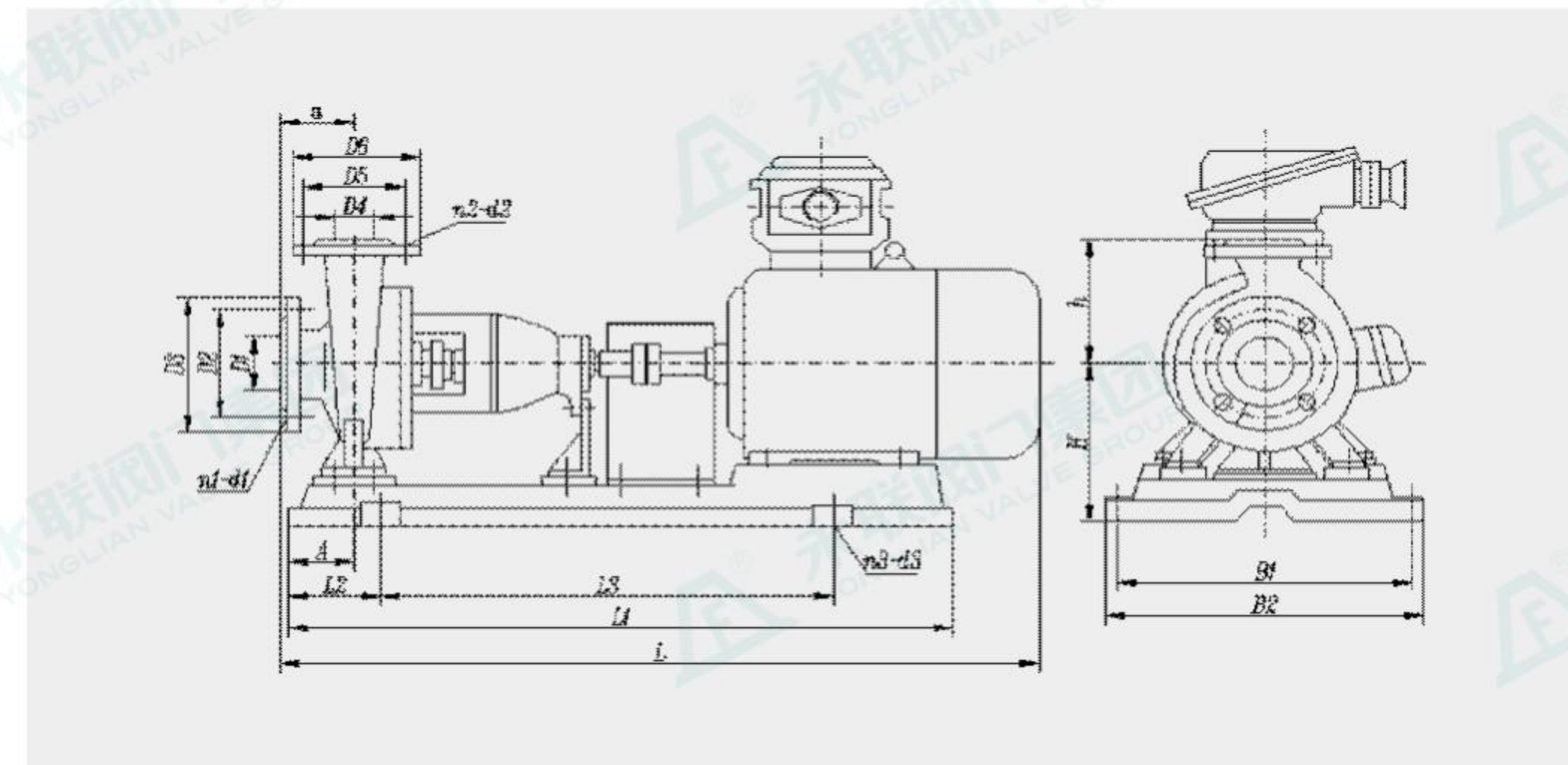

G

**IHF型氟塑料合金离心泵**  
Fluoroplastic alloy centrifugal pump

衬氟水泵系列  
Fluorine Lined Water Pump Series

规格型号 Specification and model	电机功率(kw) Motor power (kw)		电机型号 Motor model		出口法兰 Outlet flange		进口法兰 Inlet flange		泵外形和安装尺寸 Pump appearance and installation dimensions 转速n=2900r/min Speed n=2900r/min													
	轴功率 Shaft power	配用功率 Allocated power	轴功率 Shaft power	配用功率 Allocated power	D6	D5	D4	n1-d1	D3	D2	D1	n3-d3	H	h	B2	B1	L3	L2	L1	L	A	a
IHF40-25-125	0.98	2.2	0.98	2.2	Y90L-2	4-N12	85	4-N16	150	110	410	4-N18	177	140	360	320	540	105	750	60	80	
IHF40-25-160	1.66	3	1.66	3	Y100L-2	4-N12	85	4-N16	150	110	410	4-N18	197	146	360	320	540	105	750	60	80	
IHF50-32-125	1.31	3	1.31	3	Y100L-2	4-N12	85	4-N16	150	110	410	4-N18	212	140	390	350	600	150	880	60	80	
IHF50-32-160	2.2	4	2.2	4	Y112M-2	4-N16	100	4-N16	165	125	50	4-N20	257	160	390	350	600	150	850	60	80	
IHF50-32-200	4.1	5.5~7.5	4.1	5.5~7.5	Y132S1-2 Y132S2-2	4-N16	100	4-N16	165	125	50	4-N20	285	180	450	400	600	170	960	60	80	
IHF65-50-125	2.13	4	2.13	4	Y112M-2	4-N16	125	4-N16	185	145	65	4-N18	212	140	396	350	600	150	880	60	80	
IHF65-50-160	3.63	5.5	3.63	5.5	Y132S1-2 Y132S2-2	4-N16	125	4-N16	185	145	65	4-N20	257	160	450	400	600	170	960	60	80	
IHF65-40-200	6.30	11	6.30	11	Y112M-2	4-N16	125	4-N16	185	145	65	4-N20	300	180	490	440	740	190	1120	60	100	
IHF80-65-160	6.7	11	6.7	11	Y132S1-2 Y132S2-2	4-N16	145	4-N16	200	160	80	4-N18	300	180	490	440	740	190	1120	60	100	
IHF80-50-200	11.5	15	11.5	15	Y112M-2	4-N16	145	4-N16	200	160	80	4-N20	380	200	540	490	740	190	1120	60	100	
IHF100-80-160	12.7	18.5	12.7	18.5	Y160M1-2	4-N16	160	4-N16	220	180	100	4-N20	300	200	540	490	840	205	1250	75	100	
IHF100-65-200	18.91	30	18.91	30	Y160M2-2	4-N16	160	4-N16	220	180	100	4-N20	380	200	540	490	840	205	1250	75	100	
IHF125-100-160	16.5	30	16.5	30	Y200L1-2	4-N16	180	4-N16	220	180	100	4-N20	405	225	610	550	940	230	1400	90	100	n=1470 r/min
IHF150-125-315	25	30	25	30	Y200L4	4-N16	210	4-N16	250	240	150	4-N20	460	355	660	600	1060	282	1564	122	140	

## MDPF型氟合金磁力离心泵

Fluorine alloy magnetic centrifugal pump

### 一、概述 Overview

氟合金磁力离心泵为传统磁力传动离心泵的派生产品，其过流部件均采用氟合金（聚四氟乙烯-F4，聚全氟乙丙烯-F46，加少量的添加剂）衬里结构。在兼备了传统磁力泵全密封、无泄露等优点的同时，充分提高了过流表面的光洁度，减少了水力摩擦损失，在相同工况下的NPSHr值均低于传统磁力泵；氟合金良好的耐腐蚀性能使其广泛应用于输送易燃、易爆、易挥发、有毒、有强腐蚀性及不允许污染的介质，除熔融碱金属、发烟硝酸等少数介质需选用不同的塑料材料外，几乎能抵抗所有的化学介质（包括浓硝酸和王水的腐蚀）。适用于石油、化工、冶金、电力制造、食品、制药、合成纤维、核工业应用等工业部门。

The fluorine alloy magnetic centrifugal pump is a derivative of the traditional magnetic drive centrifugal pump, and its flow parts are all lined with fluorine alloy (polytetrafluoroethylene-F4, Polyperfluoroethylene propylene-F46, with a small amount of additives). It has the advantages of full sealing and no leakage of the traditional magnetic pump, and fully improves the smoothness of the flow surface and reduces the hydraulic friction loss. The NPSHr value under the same working conditions is lower than that of the traditional magnetic pump; Corrosion resistance can make it widely used in transporting flammable, explosive, volatile, toxic, highly corrosive and non-polluting media. Except for a few media such as molten alkali metal and fuming nitric acid, different plastic materials need to be selected. It can resist almost all chemical media (including the corrosion of concentrated nitric acid and aqua regia). It is suitable for industrial sectors such as petroleum, chemical industry, metallurgy, power manufacturing, food, pharmaceutical, synthetic fiber, and nuclear industry applications.

### 二、MDPF系列磁力传动离心泵的特点 Characteristics

- 1) 采用ISO2858标准，方便替代化工泵；全密封、无泄露、无污染。
- 2) 动轴式结构，隔离套不承受内转子的支撑力，解决了传统塑料磁力泵支撑薄弱的问题。
- 3) 采用全塑（单层或双层）隔离套，替代了传统的金属衬里结构，磁涡流损耗为零，泵的效率显著提高。
- 4) 叶轮、内转子均采用碳钢或不锈钢连体模压结构，传递扭矩大，最大流量可达200m<sup>3</sup>/h，扬程可达50m。
- 5) 采用独特的轴向力平衡系统和介质自润滑系统，轴承的自然磨损率低，故障率低。
- 6) 采用后拉式结构，无需拆卸管道，当电机与支架向后拉出时，泵的设计结构能防止液体不会流出。
- 7) 30KW以上的MDPF型磁力泵均采用分体式结构设计；当输送介质温度较高时，我厂采用内衬PFA并结合耐高温永磁体材料定做高温氟塑料磁力传动离心泵，使用温度范围可达-4℃~150℃。

### 三、型号意义 Model meaning

MDP F 50-32-160 A



### 四、MDPF型氟合金磁力离心泵的结构图 Structure chart

1. 泵体
2. 叶轮与轴组合
3. 圆柱销
4. 轴承
5. 轴套
6. 隔套
7. 轴承体组合
8. 隔离套组合
9. 前密封圈
10. 联接体
11. 内转子组合
12. 外转子组合
13. 后密封圈
14. 锁紧螺母
15. 密封螺母
16. 电机
17. 机座

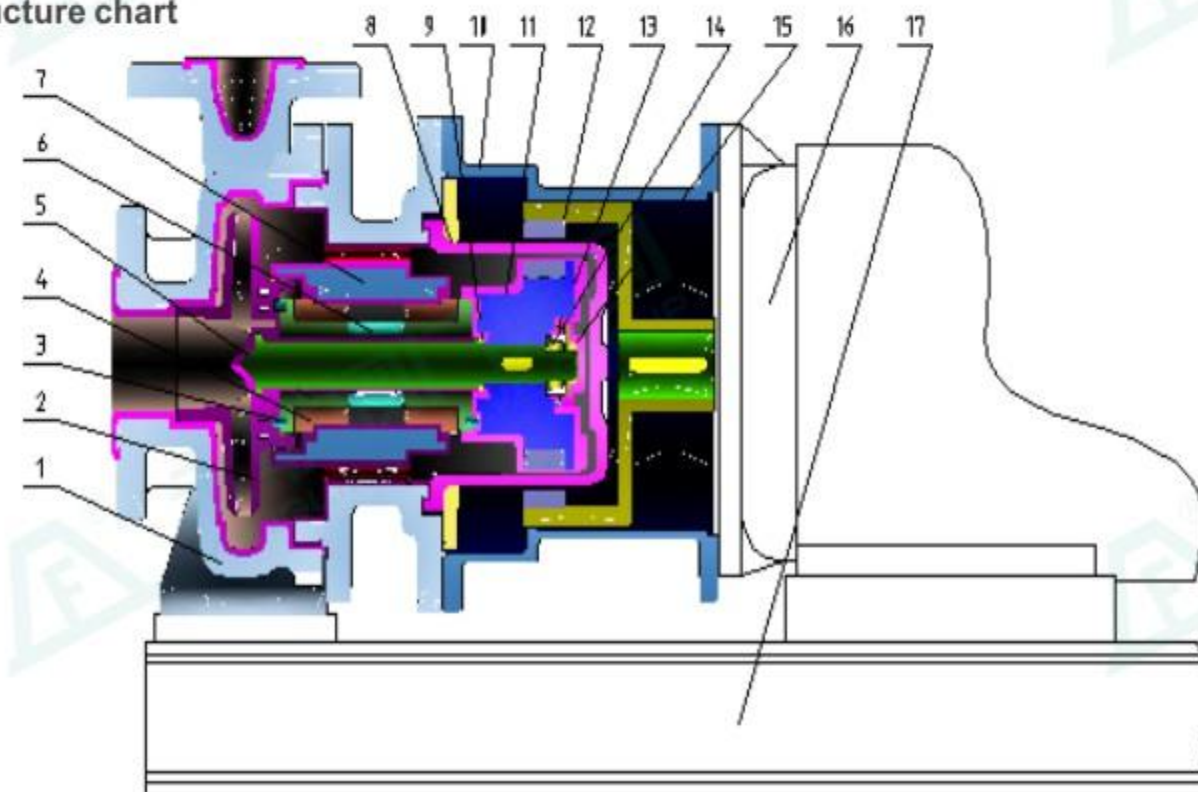

## MDPF型氟合金磁力离心泵

Fluorine alloy magnetic centrifugal pump

### 五、如需要MDPF型磁力离心泵的外形及安装尺寸图请直接联系公司技术部。

If you need the outline and installation dimensions of the MDPF type magnetic centrifugal pump, please contact the company's technical department directly

### 六、性能与参数表 Performance and parameter table

规格型号 Specification and model	流量Q Flow Q		扬程H (m) Head	汽蚀余量 (m) NPSH	转速n (r/min) Speed	口径φ(mm) Caliber φ(mm)		使用温度 (°C) Operating temperature	电机功率 (kw) Power		
	(m <sup>3</sup> /h)	(L/s)				进口 Import	出口 Export				
MDPF25-20-125	1.6	0.44	20	3.0	2900	25	20	-20~80	0.55		
MDPF25-20-160			30	3.0					0.75		
MDPF32-25-125	3.2	0.89	20	3.0		32	25		-20~100	1.1	
MDPF32-25-160			32	3.0						1.5	
MDPF40-32-125	6.3	1.75	20	3.0		40	32			-20~100	2.2
MDPF40-32-160			32	3.0							3
MDPF50-32-125	12.5	3.47	20	3.0		50	32	-20~100			3
MDPF50-32-160			32	3.0							4
MDPF50-32-200	25	6.94	50	3.5		65	50		-20~100		7.5
MDPF65-50-125			20	3.0							4
MDPF65-50-160	50	13.89	32	3.0		80	65			-20~100	5.5
MDPF65-40-200			50	3.5							11
MDPF80-65-125	50	13.89	20	4.0	100	80	-20~100	7.5			
MDPF80-65-160			32	4.0				11			
MDPF80-50-200	100	27.78	50	4.0	125	50		-20~100	18.5		
MDPF100-80-125			20	4.5					18.5		
MDPF100-80-160	200	55.56	32	4.5	100	65			-20~100	22	
MDPF100-65-200			50	4.5						30	
MDPF125-100-160	200	55.56	30	5.0	125	100	-20~100			30	

注：泵的吸入压力应不超过0.2MPa,泵的额定压力为1.6MPa;如用户所需参数不在此表范围，我厂可根据用户要求予以调整；当输送介质比重大于或小于1时，泵的配套功率可做适当调整。具体请致电：0577-8681 0423 / 2886 6111

Note: The suction pressure of the pump should not exceed 0.2MPa, and the rated pressure of the pump is 1.6MPa; If the parameters required by the user are not within the scope of this table, our factory can adjust them according to the user's requirements; When the specific gravity of the conveying medium is greater than or less than 1, The matching power of the pump can be adjusted appropriately. For details, please call 0577-8681 0423/2886 6111.

### 七、型谱图 Type spectrum

